

HDBaseT Extension Card Installation Guide

1. HDBaseT Extension Card Installation Steps

⚠ Note:

Must be operated in the power-off status when installing the HDBaseT extension card

①

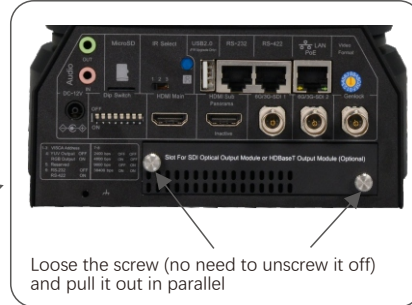

Loose the screw (no need to unscrew it off) and pull it out in parallel

②

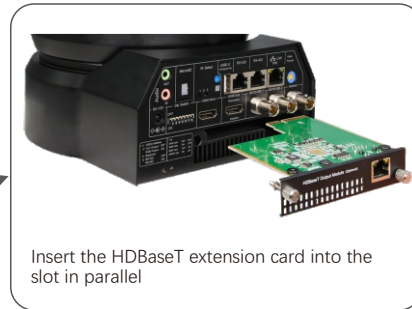

Insert the HDBaseT extension card into the slot in parallel

③

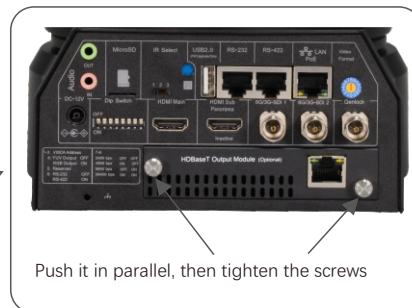

Push it in parallel, then tighten the screws

④



HDBaseT interface can provide camera power supply, 4K video signals, RS232 / 422 and infrared control signals, audio. support transmit 80-100 meters via a CAT5e / 6A network cable

2. HDBaseT extension card suitable for model

- BC-9-4K12S-S6MN/B BC-9-4K12S-S6MN/W BC-9-4K12S-S3MN/B BC-9-4K12S-S3MN/W